



2 Vine Cottages, Handley Street, Ebbesbourne Wake, Salisbury, Wiltshire, SP5

£375,000 Freehold

## About The Property

A charming semi-detached thatched cottage in the centre of this popular Chalke Valley village, extended to provide good accommodation together with ample parking and a large garden. offered with no chain.

This is a lovely period home with brick and flint elevations under a thatched roof set back from the road and situated on the edge of the small village of Ebbesboume Wake which has a thriving public house and is surrounded by wonderful countryside of the Cranborne Chase (a dark sky reserve). There is ample parking to front and side with a five bar gate which leads through to the rear garden and overlooks fields and woodland. Quantum dimplex heaters have been installed and the windows are double glazed.

The entrance door is to the rear of the cottage and leads into a boot room offering ample space for coats and storage. This opens into a lobby area with cloakroom consisting of a low level wc and hand basin together with adjacent bathroom with panel bath, hand basin, heated towel rail and airing cupboard housing the lagged hot water tank. The lobby continues into the kitchen which has a range of wood effect work surfaces with base and wall mounted cupboards and drawers, built in dishwasher, built in oven and hob with extractor hood over, AGA (decommissioned) and wood effect flooring. This is semi open plan to the sitting room which has double doors out to the garden. Beyond this room is a really large main bedroom and a second double room.



- Character Cottage
- Chalke Valley Village
- Ample Parking
- Large Garden
- Two Bedrooms
- Large Sitting Room
- Excellent Pub within walking distance
- Kitchen and Bathroom





W  
WHITES



## Ground Floor

Approx. 86.2 sq. metres (928.2 sq. feet)

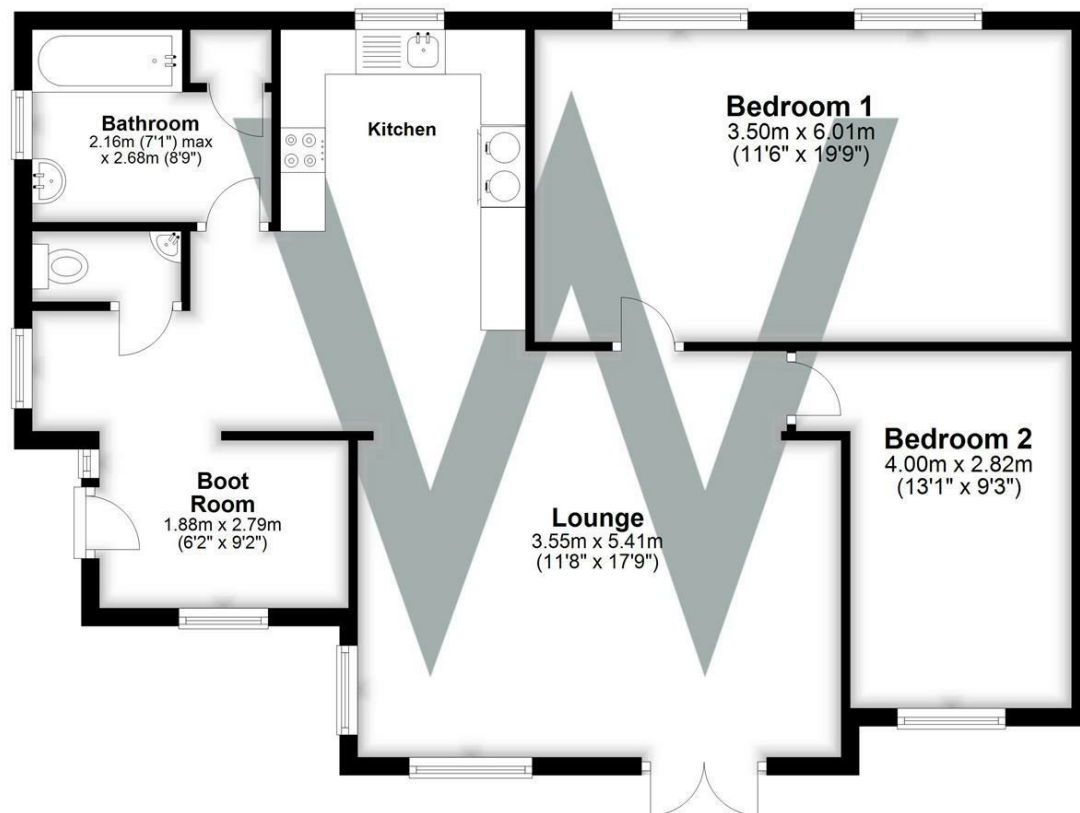

Total area: approx. 86.2 sq. metres (928.2 sq. feet)

## Further Information

Local authority: Wiltshire Council

Council Tax: D - £2297.15 (2025/2026)

Tenure: Freehold

Services: Mains water and electricity. Private drainage.

Heating: Electric heating.

Directions: From Salisbury take the A345 Blandford Road. At Coombe Bissett turn right to Bishopstone. Continue through Broadchalke and after about 3 miles enter Ebbesboume Wake where the property will be seen at the end of the village on the left.

What3words: ///stems.melt.unpainted

Energy Efficiency Rating		Current	Potential
Very energy efficient - lower running costs			
(92 plus) A			
(81-91) B			88
(69-80) C			
(55-68) D		55	
(39-54) E			
(21-38) F			
(1-20) G			
Not energy efficient - higher running costs			
England & Wales		EU Directive 2002/91/EC	